



**TECHNICAL DATA**

Developed to be installed in environments with the possibility of chemical aggression, the "PL" series actuators are made with reinforced plastic body. The patented system of a shaft with direct elastomer cured on it, is a total seal between the pressurized chambers.

Different sizes are available, able to operate up to a maximum of 2" and butterfly valves up to DN50.

The main features can be:

- supply with air or any other non-fluid
- aggressive with pressure up to 10 bar
- 90 degree rotation angle
- operation with temperatures between -20 and + 60 degrees C.
- constant torque for the entire rotation range
- all metal parts are in AISI 316 stainless steel

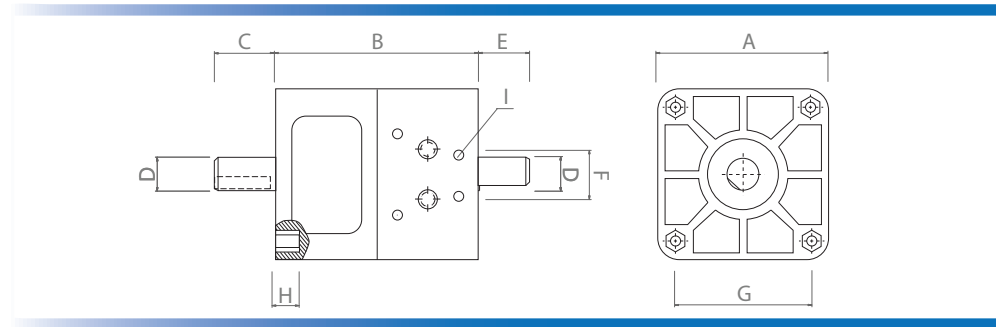

**DIMENSIONS**

MODEL	A	B	C	D	E	F	G	H	I		
	mm	mm	mm	mm	mm	mm	Gas	M	mm		
5.P0	38	47	25	7	7	22	1/8"	28	M4	20	Dripping ISO 5599/1
5.P3	76	92	28	15	23	18	1/8"	60	M5	8	

**TORQUE**

ANGLE	MODEL	COUPLE IN daNm (Kgm) a:							DISPLACEMENT	PRESS. MAX	WEIGHT
		2 Bar	3 Bar	4 Bar	5 Bar	6 Bar	8 Bar	10 Bar			
90°	5.P0	1,1	1,7	2,3	2,8	3,4	4,5	—	Cc/angle	Air/Fluid	Kg
	5.P3	12	18	24	30	36	48	60	9	8 Bar	0,1
									101	10 Bar	0,7